



# DIMMER

Is used for regulating the intensity of the light from 0 to maximum

**Nominal voltage 220V AC**  
**Frequency 50 Hz**  
**Power 1200 W**

email: [vds@mt.net.mk](mailto:vds@mt.net.mk)  
[vds@t-home.mk](mailto:vds@t-home.mk)

## INSTALLATION AND CONNECTION

The dimmer is used for regulating the light intensity of light bulbs with metal filament and halogen light bulbs. It cannot be used for regulating the light of fluorescent light bulbs. With the use of this light dimmer, energy is saved and the lifespan of the light bulb is prolonged.

The dimmer is installed in the place of a regular switch (interrupter) in a F60 mm opening and is connected with the wires. Prior to installation, the fuse which powers the light bulb should always be disconnected. The regulation button (1) should be removed by pulling and afterwards the two screws should be unscrewed, the inside mask (2) should be removed as well as the external mask (3). The screws (6) should be unscrewed and the phased wire should be connected.

Install the dimmer in the opening and fasten it by tightening the screws to the tightening jaws (8). Then put the external mask (3) on the metal board (4) together with the inside mask (2). Next, tighten both screws and set the regulation button with a push.

Turn the power on. The light dimmer is ready to use.

If the fuse (5) burns out, replace it with a proper one (4A). When replacing the fuse, the dimmer must be disconnected from the voltage i.e. from a fuse which powers the light bulb.

### CONNECTION DIAGRAM

#### DIMMER

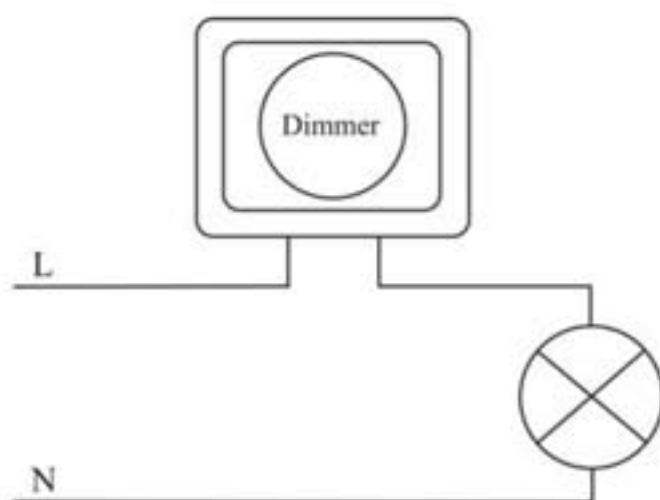
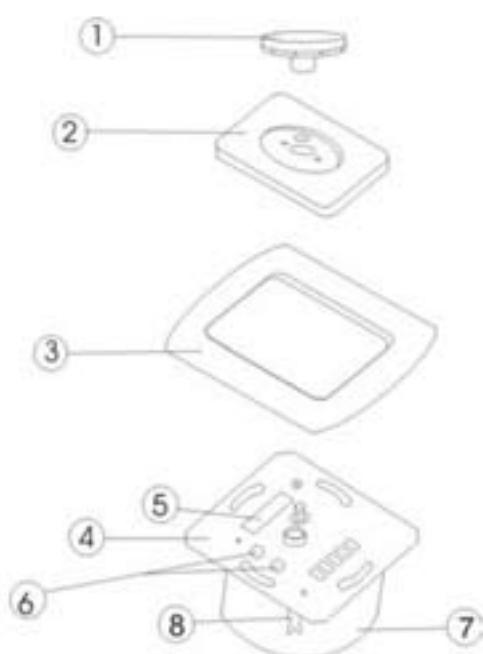

L – phase wire  
N – neutral wire

(1) regulation button  
(2) inside mask  
(3) external mask  
(4) metal board  
(5) fuse

(6) screws for connection of the wires  
(7) dimmer opening  
(8) tightening jaws